

Fitting Instructions

Revo Torque Mount Kit VAG 2.0 TFSI/TSI MK5/6 Chassis

Fitting Difficulty



Dealer Fit Recommended

Contents

Description	Quantity
Revo Torque Mount Arm	1
Revo Torque Mount Link Plate	1
Revo Torque Mount Bush	2
Revo Bolt Bushing	1
Stainless Steel M10x1.5x60 Socket Head Bolt	1
Stainless Steel M10x1.5x25 Socket Head Bolt	1
Stainless Steel M10 Flat Washer	2
Revo TFSI Torque Insert	1
Revo TSI Torque Insert	1
Small Filler Washer	1
Large Backing Washer	1
10.9 M14x1.5x70 Flange Bolt	1

Recommended Tools

Tools	Size
Ratchet	
Extension	
Sockets	16, 18, 21mm
Hex Key	8mm
Hydraulic Jack	
Block of Wood	50x100mm or equivalent
White Lithium/Red Grease	



Before starting, please ensure that the engine is cool. Engine temperatures can remain high for a substantial amount of time after use.



Fitting Instructions

Revo Torque Mount Kit VAG 2.0 TFSI/TSI MK5/6 Chassis

Fitting Difficulty



Dealer Fit Recommended

1 Raise to gain access to the underside of the car.

2 Using a 21mm socket remove the OE subframe mount bolt holding the OE torque mount arm to the two rubber subframe mounts.



3 Using a 16mm socket remove the two bolts that couple the torque mount link and bracket to the transmission. Remove both the torque mount arm and link bracket.

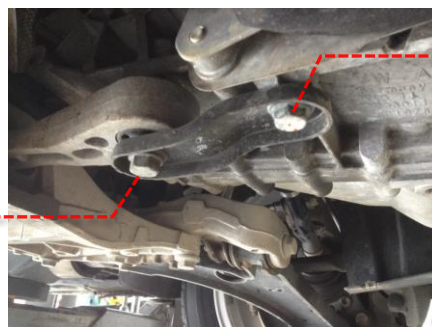

4 Using some white lithium or red grease, heavily grease all the walls of the three Revo insert uprights to ease insertion. Note: TFSI insert pictured, TSI insert is installed the same way.

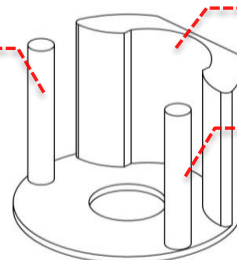

5 Place the insert into the corresponding locations on the OE rubber subframe mount. The back edge of the Revo insert should be parallel with the steering rack during installation. It is useful to use a hydraulic jack with a block of wood at this point to apply constant pressure to the base of the insert until it sits flush with the bottom of the rubber subframe mount.

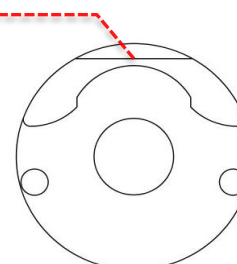

Fitting Instructions

Revo Torque Mount Kit VAG 2.0 TFSI/TSI MK5/6 Chassis

Fitting Difficulty



Dealer Fit Recommended

- 6 Insert the Revo torque mount arm into the rubber subframe mount. Area (A) inserts between the rubber subframe mounts. When you look through the mount from the bottom of the vehicle the hole should be concentric with both the rubber subframe mount holes.

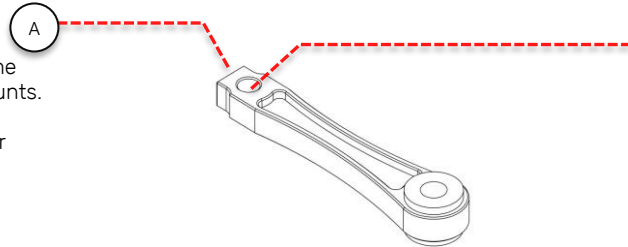

revo

- 7 Loosely install the small filler washer, large backing washer and M14 bolt, as shown, to hold the Revo torque arm in place. The filler washer will sit inside the centre hole on the insert against the base of the rubber subframe mount.

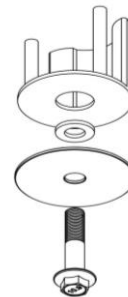

- 8 Install the Revo link plate as shown. Be sure that the Revo bolt bushing is installed as shown. With an 8mm hex socket install both bolts with washers loosely.

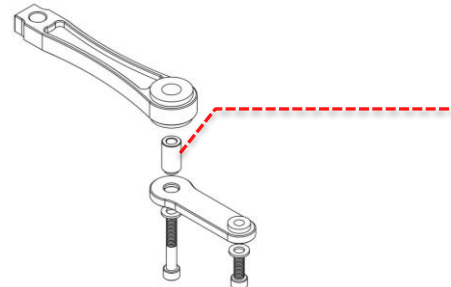

- 9 Check that the Revo torque arm protrudes through the centre of the subframe provision. Adjust accordingly if required then torque the two socket head bolts to 41Nm.



- 10 Torque the M14 bolt on the rubber subframe mount to 100Nm. The Revo bush should be touching the base of the rubber subframe mount. Refit all OE parts back to vehicle. Reinstallation is the reverse of removal. Follow any factory torque specification during reinstallation of OE parts. Test drive the vehicle to ensure there are no leaks/part interference during operation. Your installation is now complete!

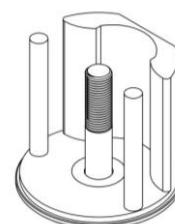

*** Dealer note: please hand the "Assembly Sheet" to the customer to retain for their records.**